

# How to clean your earmould

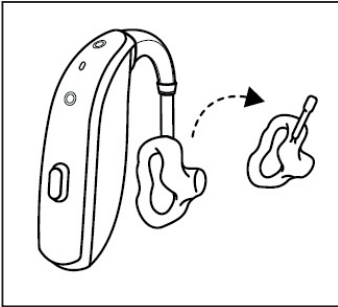

First of all, remove the earmould and tubing from your hearing aids.

Next, clean the earmould using warm soapy water.

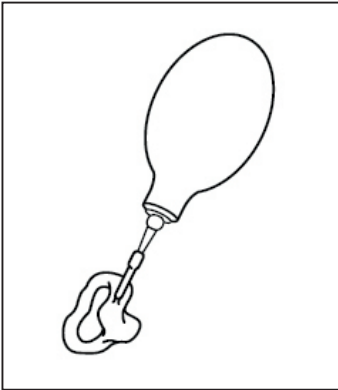

Before reattaching the earmould to the hearing aid, ensure it is fully dry and remove any residual water from the tube by either shaking firmly or using a puffer.



For further support, scan the QR code or visit our patient support portal at: [danalogic.co.uk/patient-portal](https://danalogic.co.uk/patient-portal)